

Společnost **MOS technik** Vám nabízí kvalitní pneumatická šroubení od renomovaného výrobce z Itálie – **SISTEM PNEUMATICA s.r.l.**



Sistem Pneumatica vyrábí pneumatická šroubení a spojovací prvky již od roku 1978. Pozornost, kterou věnuje kvalitě svých výrobků, ji přivedla k certifikaci "ISO 9001" již v roce 1997.

Více než 30 let zkušeností v oblasti návrhu a výroby pneumatických komponent vedlo mimo jiné ke spolupráci s externími vědeckými subjekty včetně kvalifikované laboratoře univerzity v Bologni, například při standardizaci šroubení dle ISO 14743. Zkušenosti a znalosti jejich techniků umožňují být ve shodě se směrnicemi ROHS a PED



Nástrčná rychloupínací šroubení (tzv. push-in) byla navržena pro použití v průmyslových zařízeních napříč odvětvími. Jejich robustní konstrukce umožňuje použití také v těžších provozech.



Konstrukce těchto šroubení umožňuje použití také v oblasti vakuové techniky! Nástrčné šroubení je možno použít až do podtlaku -0,75 bar.

## Technické parametry

pracovní tlak	.....	- 0,75 bar až + 16 bar												
pracovní teplota	.....	- 10 °C až + 80 °C												
materiál těla	.....	mosaz niklovaná (EN 12164-C614N)												
materiál o-kroužku	.....	olejivzdorná NBR, bez silikonu												
pro plastové trubky	.....	polyamid (PA6), polyuretan, polyetylen, teflon, rilsan (PA11/12)												
tolerance průměru trubky	.....	± 0,05 (ø 4 až ø 10); ± 0,1 (ø 12 až ø 14)												
připojovací závit	.....	válcový závit UNI-ISO 228/1 metrický závit UNI 5542-65 vnitřní závit UNI-ISO 228/1												
utahovací moment [Nm]	.....	<table border="1" data-bbox="762 1630 1181 1706"> <thead> <tr> <th>M5</th> <th>M7</th> <th>1/8</th> <th>1/4</th> <th>3/8</th> <th>1/2</th> </tr> </thead> <tbody> <tr> <td>1,5±0,5</td> <td>2±1</td> <td>5±1</td> <td>7±1</td> <td>8±1</td> <td>10±1</td> </tr> </tbody> </table>	M5	M7	1/8	1/4	3/8	1/2	1,5±0,5	2±1	5±1	7±1	8±1	10±1
M5	M7	1/8	1/4	3/8	1/2									
1,5±0,5	2±1	5±1	7±1	8±1	10±1									

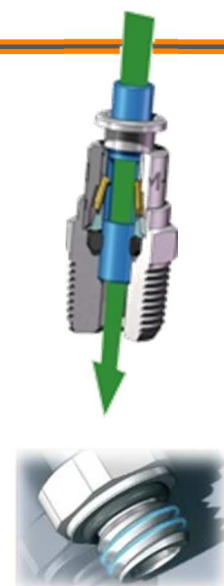

Pro montáž šroubení Sistem Pneumatica je možno použít vnější i vnitřní šestihřanné klíče. Šestihřanný otvor uvnitř šroubení Vám umožní jednoduchou montáž i v malých prostorách.

### KNA

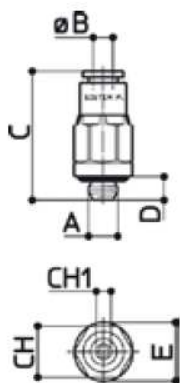

	A	B	C	D	E	F	G	CH	CH1	GR
M5	4	22	4	10				9	2,5	6
M6x0.75	4	23	5	10				9	2,5	6
M6x1	4	23	5	10				9	2,5	6
M8x1	4	22	6	10,4				9		6
M5	5	22	4	11				10	2,5	7
M5	6	26	4	13				12	2,5	13
M6x1	6	26	5	13				12	2,5	14
M8x1.25	6	27,5	6	13				12	4	12
M10x1	6	24,5	6	14,3				13	4	12
M12x1	6	26	8	17,5				16	4	19
M12x1.25	6	26	8	17,5				16	4	19
M12x1.5	6	26	8	17,5				16	4	18
M8x1.25	8	29,5	6	15,5				14		17
M10x1	8	29,5	6	15,5				14	5	18
M12x1	8	29	8	17,5				16	6	17
M12x1.25	8	29	8	17,5				16	6	20
M12x1.5	8	29	8	17,5				16	6	19

### KNA

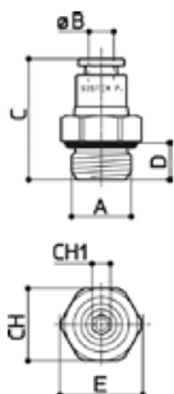

	A	B	C	D	E	F	G	CH	CH1	GR
G1/8	4	20	6	14,3				13	3	8
G1/4	4	23	8	17,5				16	3	17
G1/8	5	22,5	6	14,3				13	4	11
G1/4	5	23,5	8	17,5				16	4	16
G1/8	6	24,5	6	14,3				13	4	12
G1/4	6	26	8	17,5				16	4	20
G1/8	8	29,5	6	15,5				14	5	18
G1/4	8	29	8	17,5				16	6	21
G3/8	8	32	10	22				20	6	36
G1/2	8	34	12	26				24	6	60
G1/8	10	33	8	19				17	5	27
G1/4	10	34	8	19				17	8	28
G3/8	10	32	10	22				20	8	36
G1/2	10	36	12	26,8				24	8	63
G1/4	12	36	8	23,5				21	8	47
G3/8	12	37	10	23,5				21	10	46
G1/2	12	37	12	26,8				24	10	61
G3/8	14	42	10	28				25	10	78
G1/2	14	44	12	28				25	12	85

### KNB

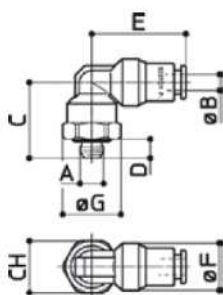

	A	B	C	D	E	F	G	CH	CH1	GR
M5	4	16	4	20	10	12,2		11		11
M5	5	19	4	20,5	11	12,2		11		13
M5	6	18	4	23	13	13		12		19
M10x1	6	20,5	6	23	13	14,3		13		21
M12x1	6	22	8	23	13	17,5		16		25
M12x1.25	6	22	8	23	13	17,5		16		24
M12x1.5	6	22	8	23	13	17,5		16		25
M10x1	8	21,5	6	25	15	15,5		14		26
M12x1	8	23	8	25	15	17,5		16		29
M12x1.25	8	23	8	25	15	17,5		16		30
M12x1.5	8	23	8	25	15	17,5		16		30

### KNB

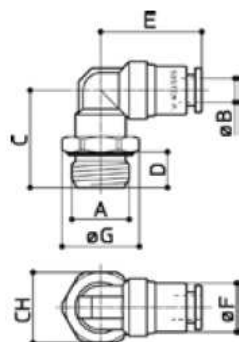

	A	B	C	D	E	F	G	CH	CH1	GR
G1/8	4	19	6	20	10	14.3	13			13
G1/4	4	21.5	8	20	10	17.5	16			19
G1/8	5	21	6	20	11	14.3	13			16
G1/4	5	23	8	20	11	17.5	16			21
G1/8	6	20.5	6	23	13	14.3	13			21
G1/4	6	22	8	23	13	17.5	16			26
G1/8	8	21.5	6	25	15	15.5	14			26
G1/4	8	23	8	25	15	17.5	16			31
G3/8	8	26.5	10	25	15	22	20			43
G1/2	8	28.5	12	25	15	26	24			56
G1/8	10	28.5	6	25	15	20.7	19			47
G1/4	10	29	8	28.5	17.5	20.7	19			48
G3/8	10	30.5	10	28.5	17.5	22	20			55
G1/2	10	33	12	28.5	17.5	26.8	24			68
G1/4	12	28.5	8	32	21.5	24.5	22			70
G3/8	12	31	10	32	21.5	24.5	22			75
G1/2	12	34	12	32	21.5	26.8	24			87
G3/8	14	34	10	36.5	25.5	29	26			123
G1/2	14	36	12	36.5	25.5	29	26			126

### KNC

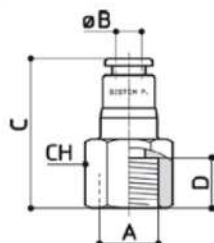

	A	B	C	D	E	F	G	CH	CH1	GR
M5	4	24	6					9		8
G1/8	4	27	8					12		11
G1/4	4	30	10					16		20
G1/8	5	27	8					12		12
G1/8	6	31	8					13		19
G1/4	6	32	10					16		24
G1/8	8	33	8					15		26
G1/4	8	34	10					16		26
G1/4	10	36	10					17		34
G3/8	10	36	11					20		41
G1/4	12	39	10					21		66
G3/8	12	39	11					21		57

### KND

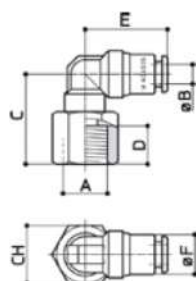

	A	B	C	D	E	F	G	CH	CH1	GR
G1/8	4	22	8	20	10			12		15
G1/8	5	22	8	20.5	11			12		17
G1/8	6	23	8	23	13			12		22
G1/4	6	25	10	23	13			16		29
G1/8	8	25	8	25	15			14		32
G1/4	8	26	10	25	15			16		35
G1/4	10	31	10	28.5	17.5			19		57
G3/8	10	33	10	28.5	17.5			20		57
G1/4	12	33	11	32	21.5			22		93
G3/8	12	33	11	32	21.5			22		85

### KNE

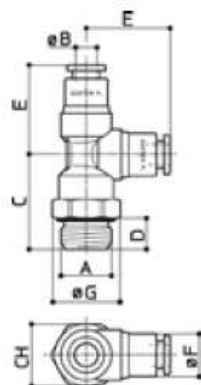

	A	B	C	D	E	F	G	CH	CH1	GR
M5	4	18	4	20	10	12.2	11			15
M5	5	19	4	20.5	11	12.2	11			17

	A	B	C	D	E	F	G	CH	CH1	GR
G1/8	4	20	6	20	10	14.3	13			18
G1/4	4	23.5	8	20	10	17.5	16			24
G1/8	5	21	6	20.5	11	14.3	13			22
G1/4	5	23	8	20.5	11	17.5	16			28
G1/8	6	22	6	23	13	14.3	14			31
G1/4	6	24.5	8	23	13	17.5	16			37
G1/8	8	24	6	25.5	15	15.5	16			43
G1/4	8	25	8	25.5	15	17.5	16			42
G1/4	10	28	8	29	17.5	20.7	19			61
G3/8	10	32	10	29	17.5	22	20			68
G1/2	10	32	12	29	17.5	26.8	24			90
G1/4	12	31	8	31	21.5	24.5	22			92
G3/8	12	33	10	31	21.5	24.5	22			97
G1/2	12	36	12	31	21.5	26.8	24			114
G3/8	14	37	10	36	25.5	29	26			160
G1/2	14	39	12	36	25.5	29	26			169

### KNF

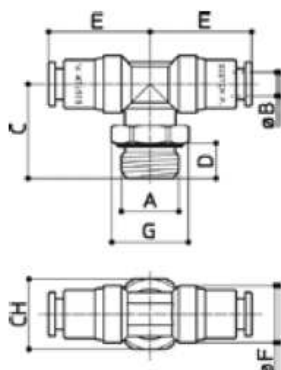

A	B	C	D	E	F	G	CH	CH1	GR
M5	4	16	4	20	10	12.2	11		15
M5	5	19	4	20.5	11	12.2	11		19
M5	6	18	4	23	13	13	12		26
M10x1	6	20,5	6	23	13	14,	13		29
M12x1	6	22	8	23	13	17.5	16		32
M12x1.25	6	22	8	23	13	17.5	16		32
M12x1.5	6	22	8	23	13	17.5	16		34
M10x1	8	21,5	6	25	15	15.5	14		38
M12x1	8	23	8	25	15	17.5	16		40
M12x1.25	8	23	8	25	15	17.5	16		40
M12x1.5	8	23	8	25	15	17.5	16		40

A	B	C	D	E	F	G	CH	CH1	GR
G1/8	4	19	6	20	10	14.3	13		17
G1/4	4	21.5	8	20	10	17.5	16		25
G1/8	5	21	6	20	11	14.3	13		21
G1/4	5	23	8	20	11	17.5	16		26
G1/8	6	20.5	6	23	13	14.3	13		29
G1/4	6	22	8	23	13	17.5	16		34
G1/8	8	21.5	6	25	15	15.5	14		37
G1/4	8	23	8	25	15	17.5	16		41
G3/8	8	26.5	10	25	15	22	20		52
G1/4	10	29	8	28.5	17.5	20.7	19		61
G3/8	10	30.5	10	28.5	17.5	22	20		68
G1/2	10	31	12	28.5	17.5	26.8	24		83
G1/4	12	28.5	8	32	21.5	24.5	22		94
G3/8	12	31	10	32	21.5	24.5	22		96
G1/2	12	34	12	32	21.5	26.8	24		113
G3/8	14	34	10	36.5	25.5	29	26		160
G1/2	14	36	12	36.5	25.5	29	26		166

### KNG

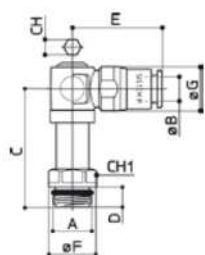

A	B	C	D	E	F	G	CH	CH1	GR
G1/8	4	30.5	5	22.5	11	11.5	4	10	26
G1/4	4	32	6	22.5	14.3	11.5	4	10	28
G1/8	6	30.5	5	25.5	11	13.8	4	10	30
G1/4	6	32	6	25.5	14.3	13.8	4	10	32
G1/8	8	30.5	5	27	11	14.5	4	10	31
G1/4	8	32	6	27	14.3	14.5	4	10	33

### KNH

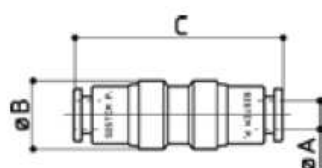

A	B	C	D	E	F	G	H	I	GR
4	10	34							11
5	11	34							12
6	13	40							21
8	15	43							27
10	18	47							43
12	21	52							62
14	25	57							107

### KNI

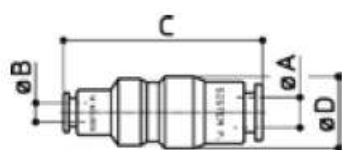

A	B	C	D	E	F	G	H	I	GR
5	4	34.5	11						12
6	4	39	13						16
6	5	39	13						20
8	6	42.5	15						27

### KNJ

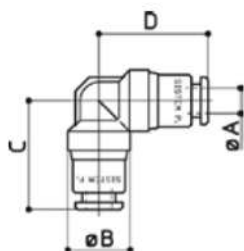

A	B	C	D	E	F	G	CH	CH1	GR
4	10	19	19				13	14	9
5	11	20	20				13	14	12
6	13	23	23				18	18	19
8	15	25	25				20	20	26
10	17.5	28.5	28.5				22	22	40
12	21.5	31.5	29.5				25	25	60
14	25.5	36.5	33.5				30	30	108

### KNK

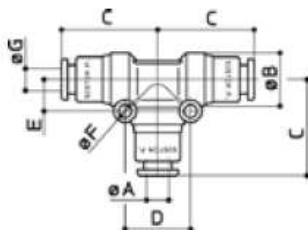

A	B	C	D	E	F	G	CH	CH1	GR
4	10	19.5	12	6	2.7	4			14
5	11	20.5				5			17
6	13	23.5	16	8	3.2	6			32
8	15	26	18	9	3.2	8			42
8-4-8	15	20.5	18	9	3.2	8			33
10	17.5	29	22	11	4.2	10			63
12	21.5	31				12			83
14	25.5	35				14			150

### KNL

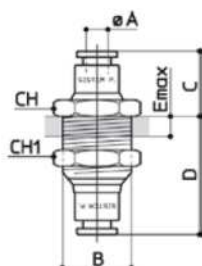

A	B	C	D	E	F	G	CH	CH1	GR
4	M12x1	14	24.5	10			13	14	20
5	M12x1	15	25	10			13	14	20
6	M15x1	16.5	28.5	11			18	18	38
8	M17x1	18.5	32	13			20	20	51
10	M20x1.5	19	32.5	13			22	22	63
12	M22x1.5	20	34	13			25	25	79
14	M27x1.5	22	34	13			30	30	132

### KNM

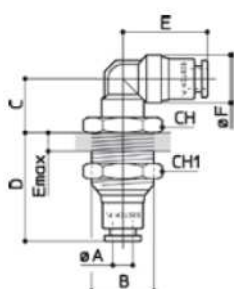

A	B	C	D	E	F	G	CH	CH1	GR
4	M12x1	12.5	24.5	10	10	20	13	14	25
5	M12x1	14.5	24.5	10	11	20.5	13	14	30
6	M15x1	14.5	28.5	11	13	23	18	18	48
8	M17x1	15.5	32	13	15	25	20	20	66
10	M20x1.5	19.5	32.5	13	17.5	28.5	22	22	89
12	M22x1.5	20.5	34	13	21.5	32	25	25	120

### KNN

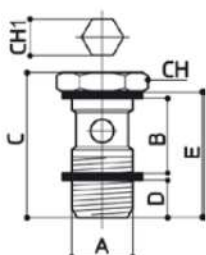

A	B	C	D	E	CH	CH1	RONDELLE	GR
M5	9	18.5	4	15	8	4	NYLON	3
G1/8	14	27	6	23	14		ALLUM.	14
G1/8	14	27	6	23	14		NYLON	14
G1/8	14	27	6	23	14		NYLON IM	14
G1/4	16	29.5	6.5	25.5	17		ALLUM.	24
G1/4	16	29.5	5.5	25.5	17		NYLON	24
G1/4	16	29.5	6.5	25.5	17		NYLON IM	24

### KNO

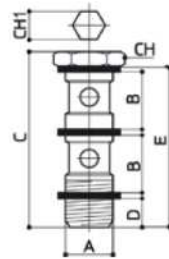

A	B	C	D	E	CH	CH1	RONDELLE	GR
M5	9	28,5	4	25	8	4	NYLON	4
G1/8	14	43	6,5	39	14		NYLON IM	19
G1/8	14	43	6,5	39	14		ALLUM.	19
G1/8	14	43	6,5	39	14		NYLON	19
G1/4	16	46	4	42	17		NYLON IM	34
G1/4	16	46	5,5	42	17		ALLUM.	35
G1/4	16	46	5,5	42	17		NYLON	32

### KNP

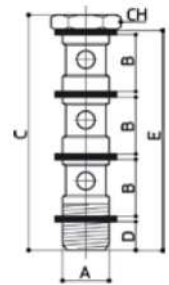

A	B	C	D	E	CH	CH1	RONDELLE	GR
G1/8	14	58,5	6,5	54,5	14		NYLON IM	25
G1/8	14	58,5	6,5	54,5	14		NYLON	25
G1/8	14	58,5	6,5	54,5	14		ALLUM.	25
G1/4	16	64	6	60	17		NYLON IM	42
G1/4	16	64	4	60	17		NYLON	47
G1/4	16	64	6	60	17		ALLUM.	46

### KNR

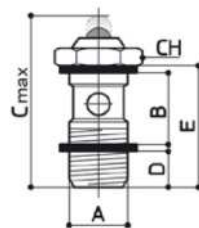

A	B	C	D	E	CH	CH1	RONDELLE	GR
M5	9	25	4	15	8		NYLON	3
G1/8	14	32	6	23	14		NYLON	13
G1/8	14	32	6	23	14		NYLON IM	13
G1/8	14	32	6	23	14		ALLUM.	13
G1/4	16	34	6,5	25,5	17		ALLUM.	22
G1/4	16	34	6,5	25,5	17		NYLON	22
G1/4	16	34	5,5	25,5	17		NYLON IM	22

### KNS

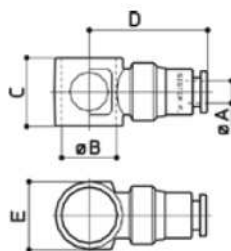

A	B	C	D	E	F	G	CH	CH1	GR
4	5,2-M5	9	19	9					8
5	5,2-M5	10	20	10					12
4	10,3-1/8	14	22,5	14					11
5	10,3-1/8	14	23	14					21
6	10,3-1/8	14	25,5	14					15
8	10,3-1/8	14	27	15					17
6	13,3-1/4	16	27	17					18
8	13,3-1/4	16	28,5	14					20
10	13,3-1/4	16	35	17					32

### KNT

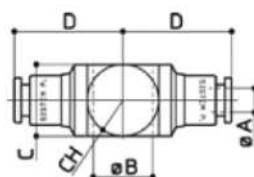

A	B	C	D	E	F	G	CH	CH1	GR
4	5,1-M5	9	19	9					12
4	10,2-1/8	14	23,5	15					29
6	10,2-1/8	14	24	15					32
8	10,2-1/8	14	25,5	15					33
6	13,2-1/4	16	26,5	17,5					39
8	13,2-1/4	16	29	17,5					44
10	13,2-1/4	16	29	17,5					54