

Společnost **MOS technik** Vám nabízí kvalitní pneumatická šroubení a fitinky od renomovaného výrobce z Itálie – **SISTEM PNEUMATICA s.r.l.**



Sistem Pneumatica vyrábí pneumatická šroubení a spojovací prvky již od roku 1978. Pozornost, kterou věnuje kvalitě svých výrobků, ji přivedla k certifikaci "ISO 9001" již v roce 1997.



Více než 30 let zkušeností v oblasti návrhu a výroby pneumatických komponent vedlo mimo jiné ke spolupráci s externími vědeckými subjekty včetně kvalifikované laboratoře univerzity v Bologni, například při standardizaci šroubení dle ISO 14743. Zkušenosti a znalosti jejich techniků umožňují být ve shodě se směrnicemi ROHS a PED



Technické parametry

pracovní tlak	- 1 bar až + 16 bar
pracovní teplota	- 10 °C až + 80 °C
materiál těla	mosaz niklovaná a hliník
připojovací závit	válcový závit UNI-ISO 228/1 metrický závit UNI 5542-65 kónický závit UNI-ISO 7/1 vnitřní závit UNI-ISO 228/1



FMA

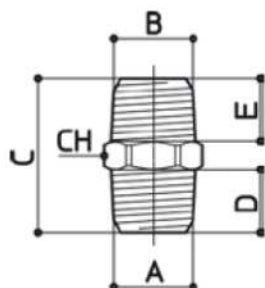

A	B	C	D	E	F	G	CH	CH1	GR
R1/8	R1/8	21	8	8			12		9
R1/8	R1/4	23	8	10			14		13
R1/4	R1/4	25	10	10			14		14
R1/8	R3/8	25	8	11			17		20
R1/4	R3/8	27	10	11			17		24
R3/8	R3/8	28	11	11			17		26
R1/4	R1/2	30	10	14			22		36
R3/8	R1/2	31	11	14			22		39
R1/2	R1/2	34	14	14			22		42
R1/2	R3/4	37	14	16.5			27		67
R3/4	R3/4	39.5	16.5	16.5			27		80
R3/4	R1	42.5	16.5	19			34		105
R1	R1	45	19	19			34		127

FMB

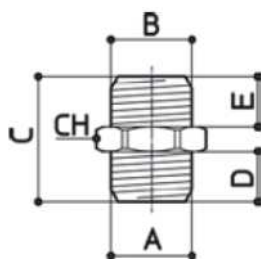

A	B	C	D	E	F	G	CH	CH1	GR
M5	G1/8	14.5	4	6			14		9
G1/8	G1/8	17	6	6			14		9
G1/8	G1/4	19	6	8			17		15
G1/4	G1/4	21	8	8			17		17
G1/8	G3/8	22	6	10			20		25
G1/4	G3/8	24	8	10			20		25
G3/8	G3/8	26	10	10			20		28
G1/4	G1/2	26	8	12			24		36
G3/8	G1/2	28	10	12			24		39
G1/2	G1/2	30	12	12			24		39
G1/2	G3/4	27.5	10	11			30		66
G3/4	G3/4	28.5	11	11			30		60

FMC

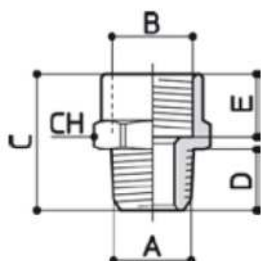

A	B	C	D	E	F	G	CH	CH1	GR
R1/8	G1/8	20	8	8			14		12
R1/4	G1/8	23	10	8			17		15
R1/8	G1/4	23	8	10			17		18
R1/4	G1/4	24	10	10			17		19
R3/8	G1/4	25	11	10			22		39
R1/8	G3/8	23	8	11			22		30
R1/4	G3/8	25	10	11			22		31
R3/8	G3/8	27	11	11			22		35
R1/2	G3/8	32	14	11			22		43
R1/4	G1/2	29	10	13			24		38
R3/8	G1/2	30	11	13			26		52
R1/2	G1/2	33	14	13			26		54
R1/2	G3/4	35	14	16.5			32		82

FMD

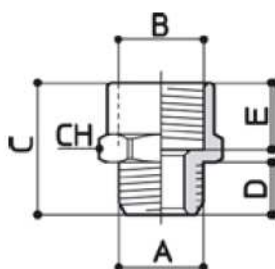

A	B	C	D	E	F	G	CH	CH1	GR
M5	G1/8	14.5	4	8			14		9
G1/8	G1/8	18	6	8			14		11
G1/4	G1/8	21	8	8			17		16
G1/8	G1/4	21	6	10			17		18
G1/4	G1/4	22	8	10			17		18
G3/8	G1/4	24	10	10			22		30
G1/4	G3/8	24	8	11			22		30
G3/8	G3/8	26	10	11			22		35
G1/2	G3/8	30	12	11			26		56
G3/8	G1/2	28	10	13			26		52
G1/2	G1/2	31	12	13			26		50

FME

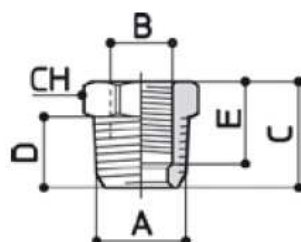

A	B	C	D	E	F	G	CH	CH1	GR
R1/8	M5	12	8	6			12		7
R1/4	G1/8	14	10	10			14		9
R3/8	G1/8	17	11	11			17		20
R1/2	G1/8	19.5	14	8			22		35
R3/8	G1/4	17	11	10			17		14
R1/2	G1/4	22	14	12			22		33
R1/2	G3/8	22	14	12			22		22
R3/4	G3/8	23	16.5	11			27		67
R3/4	G1/2	23	16.5	14			27		52

FMF

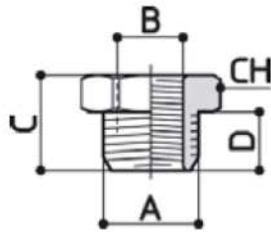

A	B	C	D	E	F	G	CH	CH1	GR
G1/8	M5	11	6				14		9
G1/4	G1/8	13	8				17		11
G3/8	G1/8	16	10				22		28
G1/2	G1/8	15.5	10				24		39
G3/8	G1/4	16	10				22		20
G1/2	G1/4	19	12				26		44
G1/2	G3/8	19	12				26		32
G3/4	G3/8	17.5	11				30		54
G3/4	G1/2	17.5	11				30		41

FMG

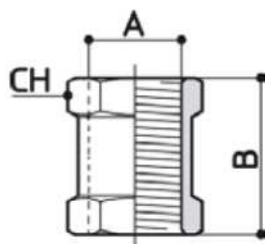

A	B	C	D	E	F	G	CH	CH1	GR
M5		11					8		3
G1/8		18					14		12
G1/4		22					17		19
G3/8		26					22		34
G1/2		30					26		55
G3/4		33					32		82

FMH

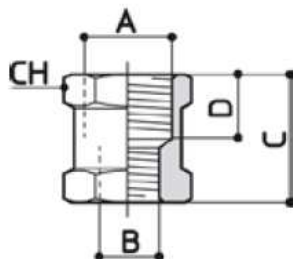

A	B	C	D	E	F	G	CH	CH1	GR
G1/8	M5	13.5	8				14		8
G1/4	G1/8	19	10				17		20
G3/8	G1/8	20	12				22		40
G3/8	G1/4	23	12				22		42
G1/2	G1/4	25	14				26		63
G1/2	G3/8	28	14				26		64
G3/4	G1/2	30	16.5				32		78

FMI

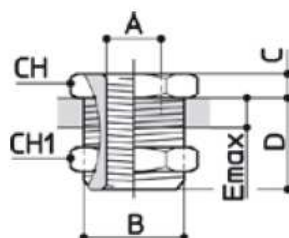

A	B	C	D	E	F	G	CH	CH1	GR
M5	M10x1	3.5	10.5	7			14	14	12
G1/8	M16x1.5	4	14	10			19	22	29
G1/4	M20x1.5	4	21	16			24	27	55
G3/8	M26x1.5	5	21	15			30	32	95
G1/2	M28x1.5	6	27	21			32	36	114

FMJ

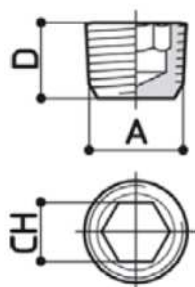

A	B	C	D	E	F	G	CH	CH1	GR
R1/8			7.5				5	3	
R1/4			10				6	8	
R3/8			11				8	14	
R1/2			13				10	25	

FMK

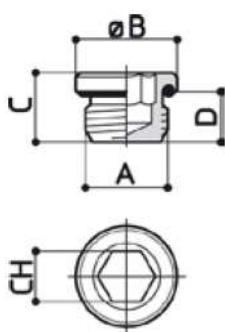

A	B	C	D	E	F	G	CH	CH1	GR
M5	8	6	4				2,5	1	
G1/8	13	9	6				6	4	
G1/4	16	11	8				8	8	
G3/8	20	14	10				10	17	
G1/2	25	16	12				12	30	

FML

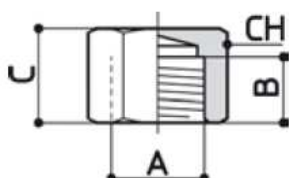
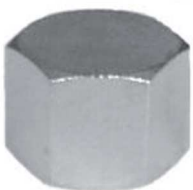

A	B	C	D	E	F	G	CH	CH1	GR
G1/8	12	12					13	9	
G1/4	13	13.5					17	16	
G3/8	16	16					21	29	
G1/2	18	18					26	47	

FMM

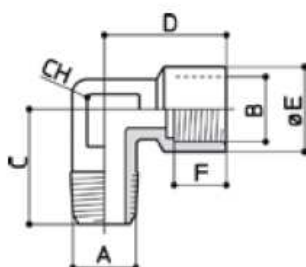

A	B	C	D	E	F	G	CH	CH1	GR
M5	M5	11.5	11	8.5	5		9	7	
R1/8	G1/8	18.5	21	13	8		11	17	
R1/4	G1/4	23	24.5	17	10		13	35	
R3/8	G3/8	26	28	21	11		17	50	
R1/2	G1/2	31.5	35	26.5	14		20	89	
R3/4	G3/4	33	36.5	32	16.5		25	124	
R1	G1	45	39	39	19		30	213	

FMN

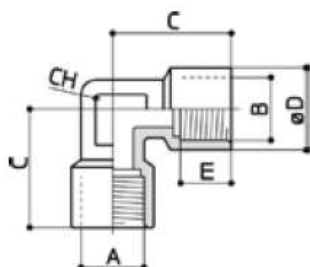

A	B	C	D	E	F	G	CH	CH1	GR
M5	M5	11	8.5	5			9		9
G1/8	G1/8	21	13	8			11		18
G1/4	G1/4	24.5	17	10			13		40
G3/8	G3/8	28	21	11			17		62
G1/2	G1/2	35	26.5	14			20		107
G3/4	G3/4	36.5	32	16.5			25		144
G1	G1	45	39	19			30		234

FMO

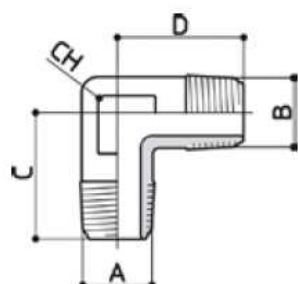

A	B	C	D	E	F	G	CH	CH1	GR
M5	M5	11.5	11.5				9		8
R1/8	R1/8	18.5	18.5				11		13
R1/4	R1/4	23	23				13		28
R3/8	R3/8	26	26				17		37
R1/2	R1/2	31.5	31.5				20		72
R3/4	R3/4	33	33				25		99
R1	R1	39	39				30		174

FMP

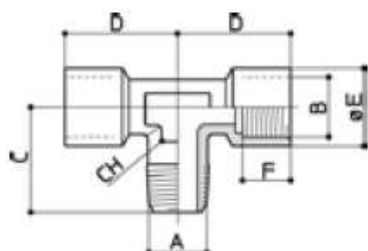

A	B	C	D	E	F	G	CH	CH1	GR
M5	M5	11.5	11	8.5	5		9		10
R1/8	G1/8	18.5	21	13	8		11		24
R1/4	G1/4	23	24.5	17	10		13		52
R3/8	G3/8	1	28	21	11		17		76
R1/2	G1/2	31.5	35	26.5	14		20		130
R3/4	G3/4	33	36.5	32	16.5		25		178
R1	G1	39	45	39	19		30		295

FMR

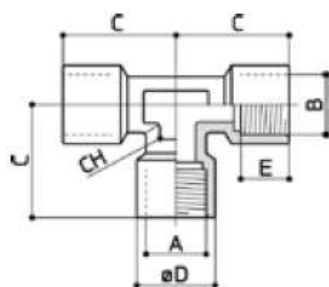

A	B	C	D	E	F	G	CH	CH1	GR
M5	M5	11	8.5	5			9		9
G1/8	G1/8	21	13	8			11		28
G1/4	G1/4	24.5	17	10			13		57
G3/8	G3/8	28	21	11			17		85
G1/2	G1/2	34.5	26.5	14			20		145
G3/4	G3/4	36.5	32	16.5			25		193
G1	G1	45	39	19			30		327

FMS

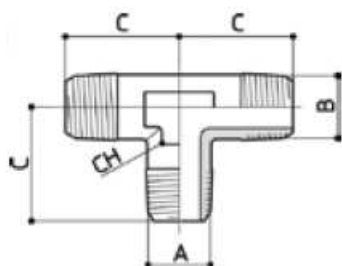

A	B	C	D	E	F	G	CH	CH1	GR
R1/8	R1/8	18.5					11		17
R1/4	R1/4	23					13		38
R3/8	R3/8	26					17		50
R1/2	R1/2	31.5					20		97
R3/4	R3/4	33					25		134
R1	R1	39					30		236

FMT

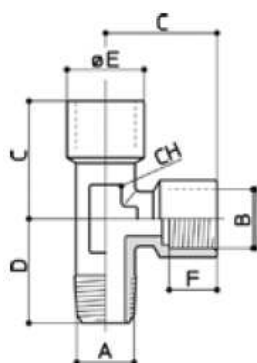

A	B	C	D	E	F	G	CH	CH1	GR
M5	M5	11	11.5	8.5	5		9		9
R1/8	G1/8	21	18	13	8		11		25
R1/4	G1/4	24.5	23.5	17	10		13		50
R3/8	G3/8	26	26	21	11		17		64
R1/2	G1/2	31	31	26.5	14		20		129
R3/4	G3/4	36.5	33	32	16.5		25		178
R1	G1	45	39	39	19		30		289

FMU

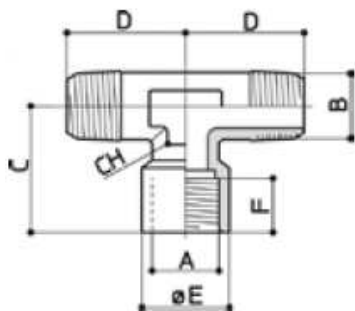

A	B	C	D	E	F	G	CH	CH1	GR
G1/8	R1/8	21	18.5	13	8		11		20
G1/4	R1/4	24.5	23	17	10		13		44
G3/8	R3/8	28	26	21	11		17		66
G1/2	R1/2	35	31.5	26.5	14		20		114
G3/4	R3/4	36.5	33	32	16.5		25		157
G1	R1	45	39	39	19		30		263

FMV

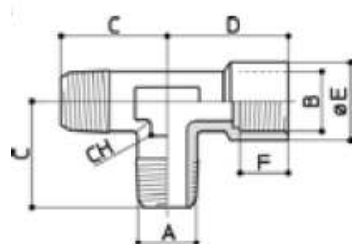

A	B	C	D	E	F	G	CH	CH1	GR
R1/8	G1/8	18.5	20	13	8		10		21
R1/4	G1/4	23.5	25.5	17	10		13		42
R3/8	G3/8	26	28	21	11		17		64
R1/2	G1/2	31	33.5	26.5	14		20		110
R3/4	G3/4	33	36.5	32	16.5		25		153
R1	G1	39	45	39	19		30		270

FMW

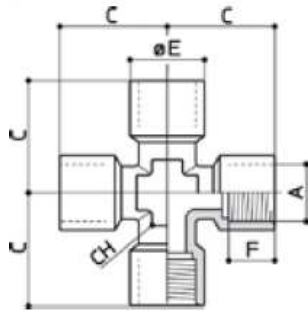

A	B	C	D	E	F	G	CH	CH1	GR
G1/8		21		13	8		10		37
G1/4		25.5		17	11		13		74
G3/8		28		21	11.5		17		110
G1/2		33.5		26.5	14		21		186

FMX

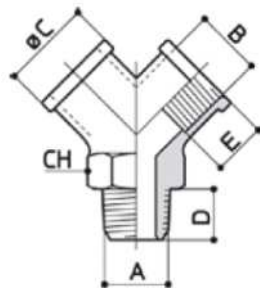

A	B	C	D	E	F	G	CH	CH1	GR
R1/8	G1/8	13.5	8	8			11		22
R1/4	G1/4	17.5	10	10			13		38
R3/8	G3/8	21	11	11			17		53
R1/2	G1/2	26	14	14			20		107

FMY

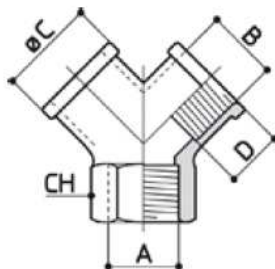

A	B	C	D	E	F	G	CH	CH1	GR
G1/8	G1/8	13.5	8				14		18
G1/4	G1/4	17.5	10				17		33
G3/8	G3/8	21	11				20		46
G1/2	G1/2	26	14				25		94

FMZ

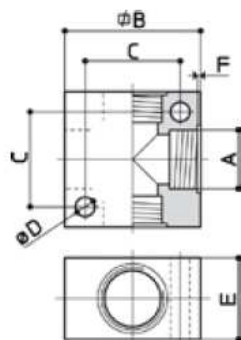

A	B	C	D	E	F	G	CH	CH1	GR
G1/8	25	17	4.5	15	0.5				17
G1/4	30	23	4.5	18	-				28
G1/4	40	26	5.5	20	0.5				63
G3/8	50	34	5.5	25	0.5				124
G1/2	50	34	5.5	30	0.5				135